

IPLD-32x128-RGB-4-S-I

Indoor Compact Insert LED Display — 4mm Pitch (Slave Unit)

PRODUCTION	SLAVE
TARGET	5,000
ACTUAL	4,712
DIFF	-288

Virtual representation of sign. Actual product may vary slightly.

SPECIFICATIONS

MECHANICAL

Height	5" (127 mm)
Length	20.2" (513 mm)
Depth	1.5" (38.1 mm)
Weight	4.5 lbs (2.0 kg)

POWER

Input	95–260 VAC at 50–60 Hz
Max Consumption	160W
Typical Consumption	40W

ELECTRICAL

Ethernet	RJ45 — 10/100 Mb Cat5
USB	2.0 Host — Type A
Audio	3.5 mm Stereo Jack
Power Input	IEC 320-C14 receptacle

DISPLAY

LED Array	32 × 128
Total Pixels	4,096
Dot Pitch	4mm
Color	Full Color R/G/B

INTERNAL

Processor	ARM A8 @ 1 GHz
Memory	1 GB SDRAM
Storage	uSD Card — 2 GB min

ENVIRONMENTAL

Operating Temp	–34 °C to 50 °C (–30 °F to 122 °F)
Humidity	Up to 90% non-condensing
Ethernet Isolation	1500 VAC min (IEEE 802.3)



DISPLAY FEATURES



Integrated 10/100 Ethernet

TCP/IP enabled out of the box with a **built-in web server**. Supports **DHCP** and **NTP** for effortless network integration.

Browser-Based Interface

Manage your display from **any web browser**—send messages, check status, configure thresholds and layouts. **No software to install.**

Dynamic Sign Layouts

Schedule any number of layouts with the built-in **Playlist manager**. Control display order, timing, and content for maximum impact.



Conditions & Program Logic

Tie program logic to sign variables. When data changes, automatically **activate** or **deactivate** messages, layouts, thresholds, and commands.



Server-Free Solution

No middleware or additional hardware needed. **Web-based interfaces** and **XML or JSON** data structures let you work directly with the sign.

Direct PLC Interfaces

Connect to standard-based PLCs:



Remote Snapshot

View exactly what's on the display from **anywhere**. The sign generates a live copy and sends it to your browser.

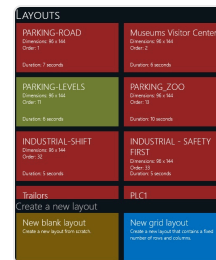

Live Message Elements

Insert **real-time data** into any message. Combine static text, scrolling text, live data fields, clocks, and bitmap graphics.

Fonts, Graphics & Effects

Choose from **44 built-in fonts**. Add entry and exit effects to bring your messages to life.

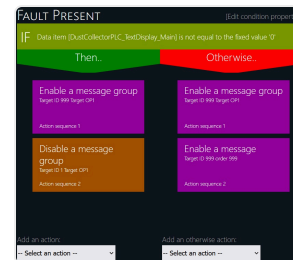

Data Thresholds

Set thresholds to automatically **change message color or state**, bringing immediate visual impact to critical events.

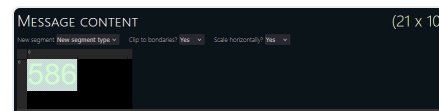

EtherNet/IP™ is a trademark of ODMA, Inc.

