

# IPLD-32x128-RGB-4-M-I

Indoor Compact Insert LED Display — 4mm Pitch (Master Unit)

PRODUCTION	MASTER
TARGET	5,000
ACTUAL	4,712
DIFF	-288

Virtual representation of sign. Actual product may vary slightly.

## SPECIFICATIONS

### MECHANICAL

Height	5" (127 mm)
Length	20.2" (513 mm)
Depth	1.5" (38.1 mm)
Weight	4.5 lbs (2.0 kg)

### POWER

Input	95–260 VAC at 50–60 Hz
Max Consumption	160W
Typical Consumption	40W

### ELECTRICAL

Ethernet	RJ45 — 10/100 Mb Cat5
USB	2.0 Host — Type A
Audio	3.5 mm Stereo Jack
Power Input	IEC 320-C14 receptacle

### DISPLAY

LED Array	32 × 128
Total Pixels	4,096
Dot Pitch	4mm
Color	Full Color R/G/B

### INTERNAL

Processor	ARM A8 @ 1 GHz
Memory	1 GB SDRAM
Storage	uSD Card — 2 GB min

### ENVIRONMENTAL

Operating Temp	–34 °C to 50 °C (–30 °F to 122 °F)
Humidity	Up to 90% non-condensing
Ethernet Isolation	1500 VAC min (IEEE 802.3)



# DISPLAY FEATURES



## Integrated 10/100 Ethernet

**TCP/IP** enabled out of the box with a **built-in web server**. Supports **DHCP** and **NTP** for effortless network integration.

## Browser-Based Interface

Manage your display from **any web browser**—send messages, check status, configure thresholds and layouts. **No software to install.**

## Dynamic Sign Layouts

Schedule any number of layouts with the built-in **Playlist manager**. Control display order, timing, and content for maximum impact.



## Conditions & Program Logic

Tie program logic to sign variables. When data changes, automatically **activate** or **deactivate** messages, layouts, thresholds, and commands.



## Server-Free Solution

No middleware or additional hardware needed. **Web-based interfaces** and **XML or JSON** data structures let you work directly with the sign.

## Direct PLC Interfaces

Connect to standard-based PLCs:



## Remote Snapshot

View exactly what's on the display from **anywhere**. The sign generates a live copy and sends it to your browser.

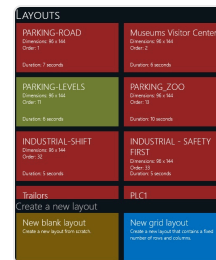

## Live Message Elements

Insert **real-time data** into any message. Combine static text, scrolling text, live data fields, clocks, and bitmap graphics.

## Fonts, Graphics & Effects

Choose from **44 built-in fonts**. Add entry and exit effects to bring your messages to life.

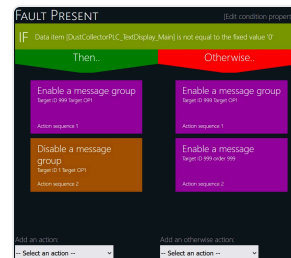

## Data Thresholds

Set thresholds to automatically **change message color or state**, bringing immediate visual impact to critical events.

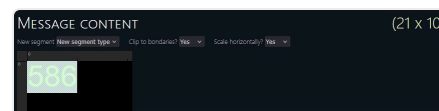

EtherNet/IP™ is a trademark of ODMA, Inc.

